

E100 Second Fix

An easy fit installed music system



Introduction

Systemline E100 is an installed music system that is easy to fit into your room. It is particularly suited to kitchens or bedrooms but could equally be used in any other room in the house including bathrooms.

The following instructions assume that you are competent in general electrical installation skills. You will need to mount a Keypad into a double gang back box and route a cable from this box to the central Hub amplifier. If you are not confident in doing this you should seek professional assistance such as a qualified electrician.

It is possible to connect TV sound or another device into the Aux input, this is shown on the system schematic.

Specifications

Keypad

Dimensions: (WxHxD) 151mm x 92mm x 33mm

Weight: 0.235 Kg

Inputs: F Connector (DAB & FM), 3.5mm Stereo Jack (Audio In), Stereo Photo (Audio In), DC Jack (18V DC In)

Outputs: Speaker IMO x 2

Power Supply

Dimensions: (WxHxD) 120mm x 38mm x 53mm

Weight: 0.425 Kg

Inputs: 100-240VAC 50-60Hz 1.6A

Outputs: 18V 2.8A

Efficiency Rating: V

Pack Contents

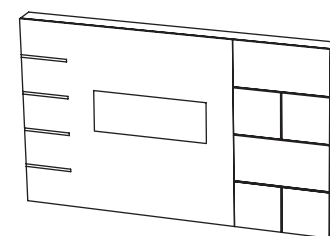

E100 Keypad x 1
(pre-fitted with IMO plugs for speaker cables)

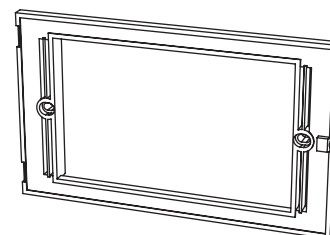

Keypad Mounting Frame x 1



3.5mm Face Plate Screws x 2



Grub Screw x 1

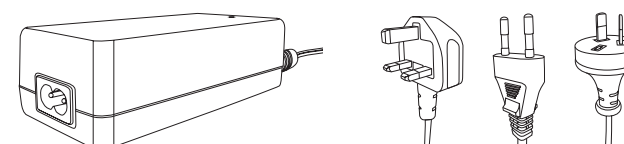

*Power Supply x 1

*Includes regional mains cable

DAB/FM Aerial Configurations

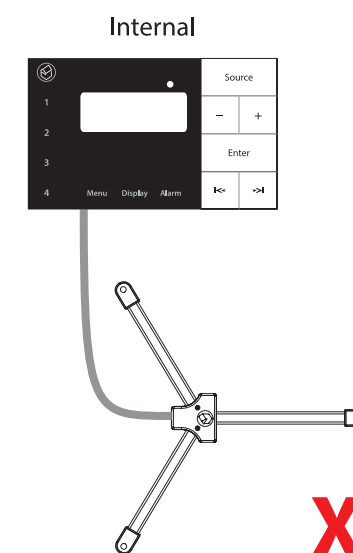
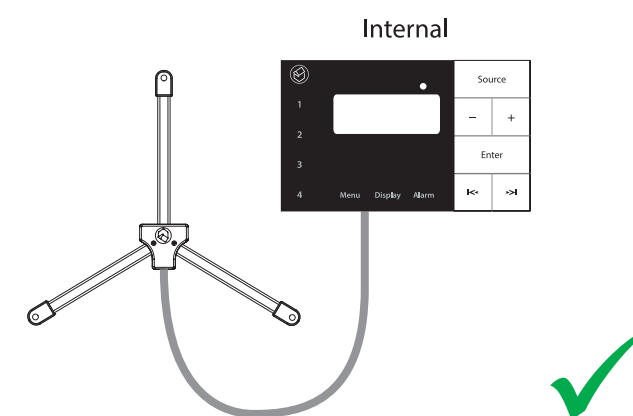
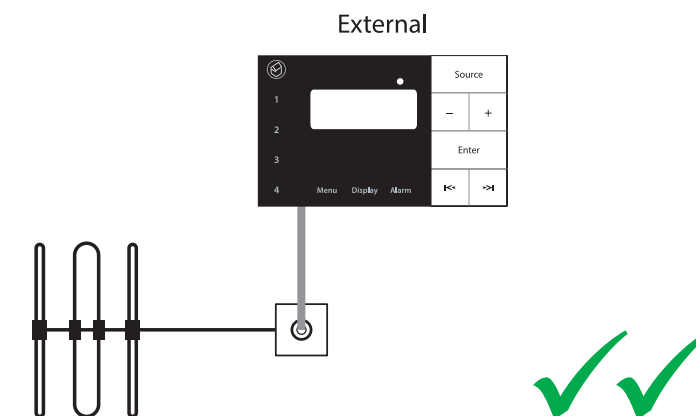

E100 Second Fix

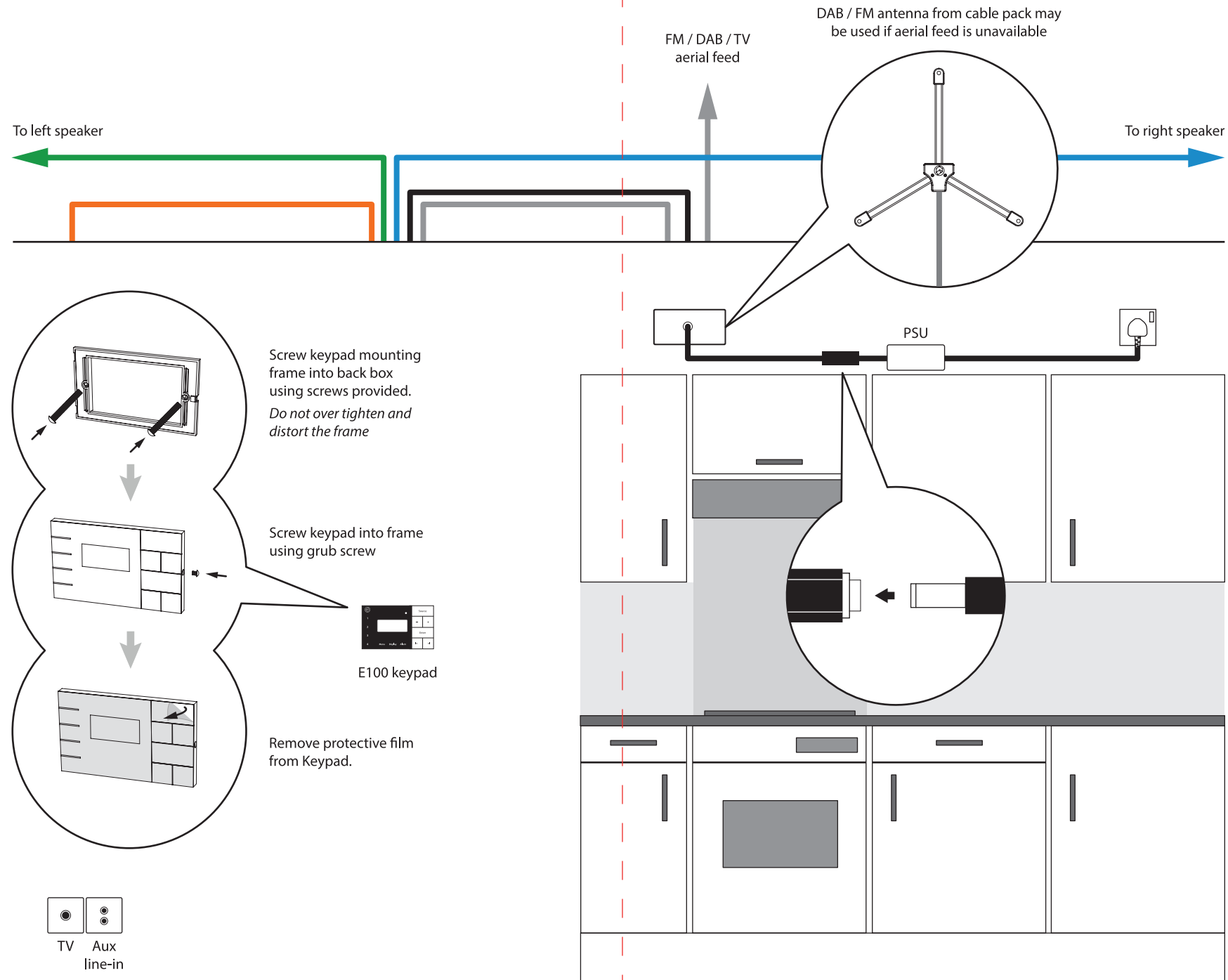

NOTES

1. Blanking plate required to cover break-out box - requires a single hole to exit DC cable
2. Optional TV sound/Aux input requires a 25 x 50mm twin phono Euro module e.g. Philex EMSPK2W or similar

KEY

- Aerial cable
- Terminated DC power cable
- Speaker cable (left)
- Speaker cable (right)
- Line-in cable (pre-terminated one end)

E100 System Schematic

